

**SG** Spindelhubgetriebe  
Klassisch

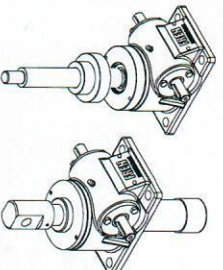

**HSG** Hochleistungs-  
Spindelhubgetriebe

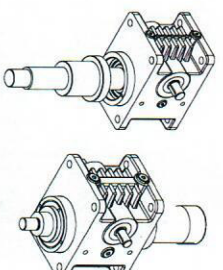

**BG** Spindelhubgetriebe  
Kubisch

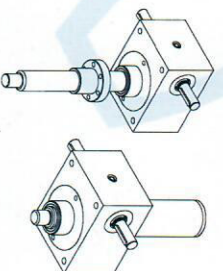

**SHG** Schnellhub-  
getriebe

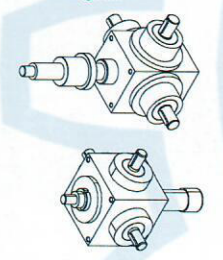

**SH** Servohub-  
getriebe

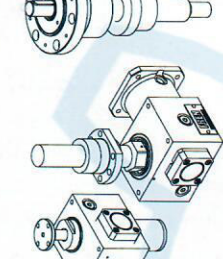

**SLA** Spindel-  
Lagerung



**TSGLR** Teleskopspindel-  
Hubgetriebe  
2-stufig

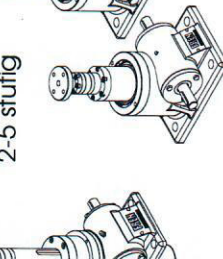

**TSG** Teleskopspindel-  
Hubgetriebe  
2-5 stufig

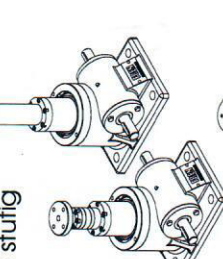

**ELZ** Elektrozyylinder  
Hochleistungs-

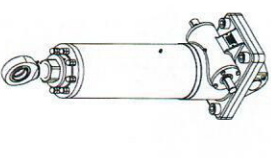

**HELZ** Hochleistungs-  
Elektrozyylinder

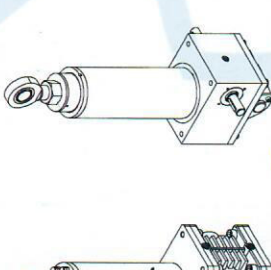

**SHGZ** Schnellhubgetriebe-

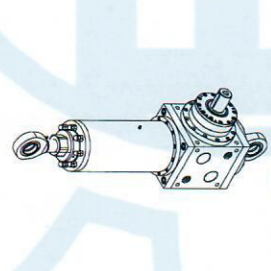

**SHELZ** Servohub-

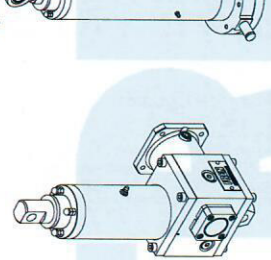

**SEZ** Spindellagerungs-  
Zylinder

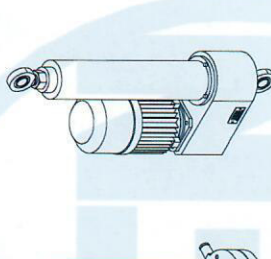

**ELZP** Elektrozyylinder

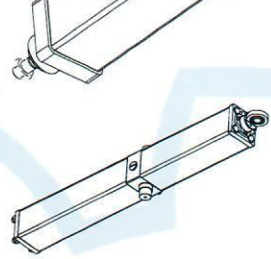

**SOLA** Solar Linear

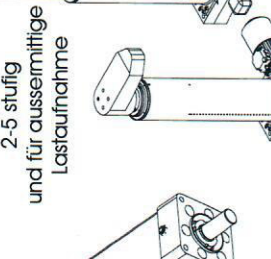

**EPNEU** Spindel-

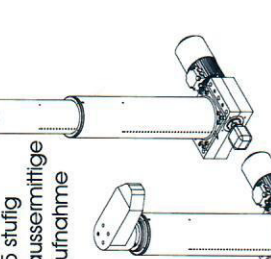

**K** Kegelaradgetriebe  
Baureihe K

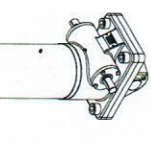

**H** Kegelaradgetriebe  
Baureihe H

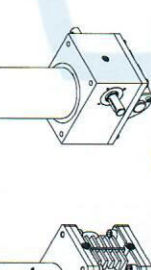

**R / GS** Elastische /  
spielfreie

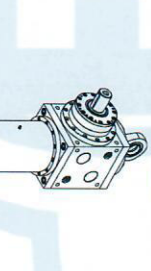

**RK** Rutschkupplung



**ZR** FREN  
Verbindungs-  
welle

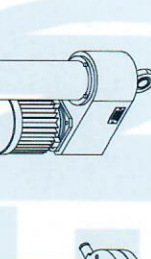

**G / GX** Elastische  
Verbindungs-  
welle

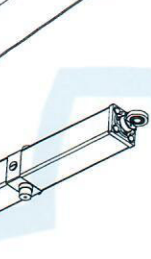

**TSZG** Teleskopspindel-  
hubzylinder  
2-5 stufig  
und für aussermittige  
Lastaufnahme

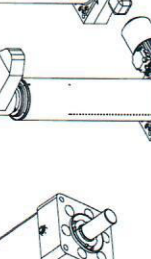

**Kardananellen**

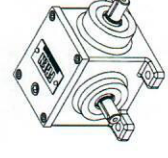

**HA** Hubanlagen

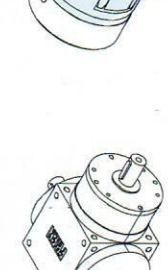

**uniCe** Schneckengetriebe

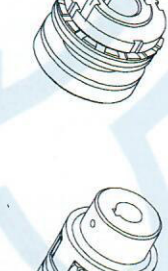

**PLG** Planetengetriebe



**SW** Seilwinde

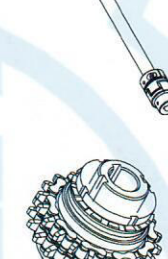

**HS** Hubsäulen



**HT** Hubfische  
mechanisch /  
hydraulisch

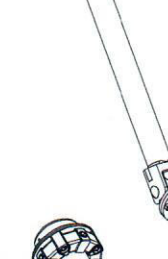

**Sondergetriebe**

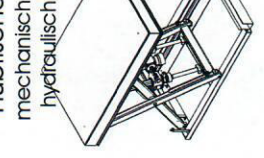

**Sondergetriebe**

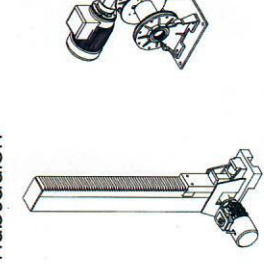

**Sondergetriebe**

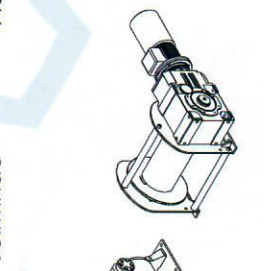

**Sondergetriebe**



**Sondergetriebe**



**Sondergetriebe**

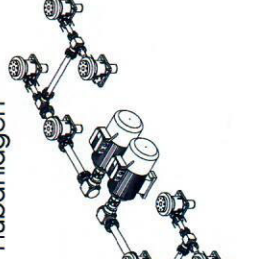

**Sondergetriebe**

